

## Specification (氣壓棒)

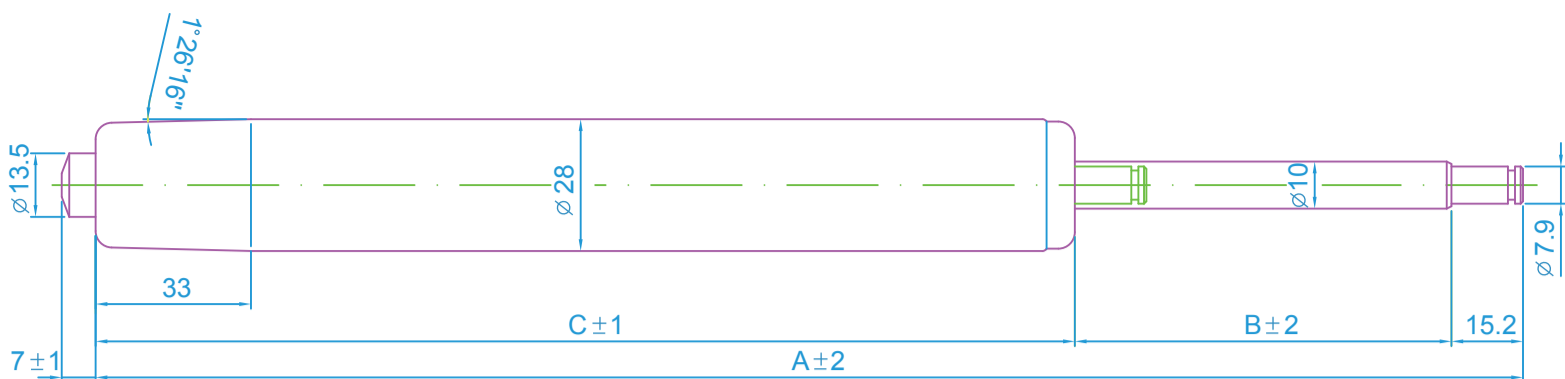

PF REF NO.	A/mm	B/mm	C/mm	Force (F1)
	Extended Length	Stroke Length	Body Length	
A07AZDW	305	80	210	150N~500N
A07CZDW	347	100	232	150N~500N
A07FZDW	394	120	259	150N~500N
A07GZDW	414	140	259	150N~500N
A07KZDW	535	200	320	150N~500N
A07LZDW	705	270	420	150N~500N

## Gas Spring With Column (氣壓棒加中管)

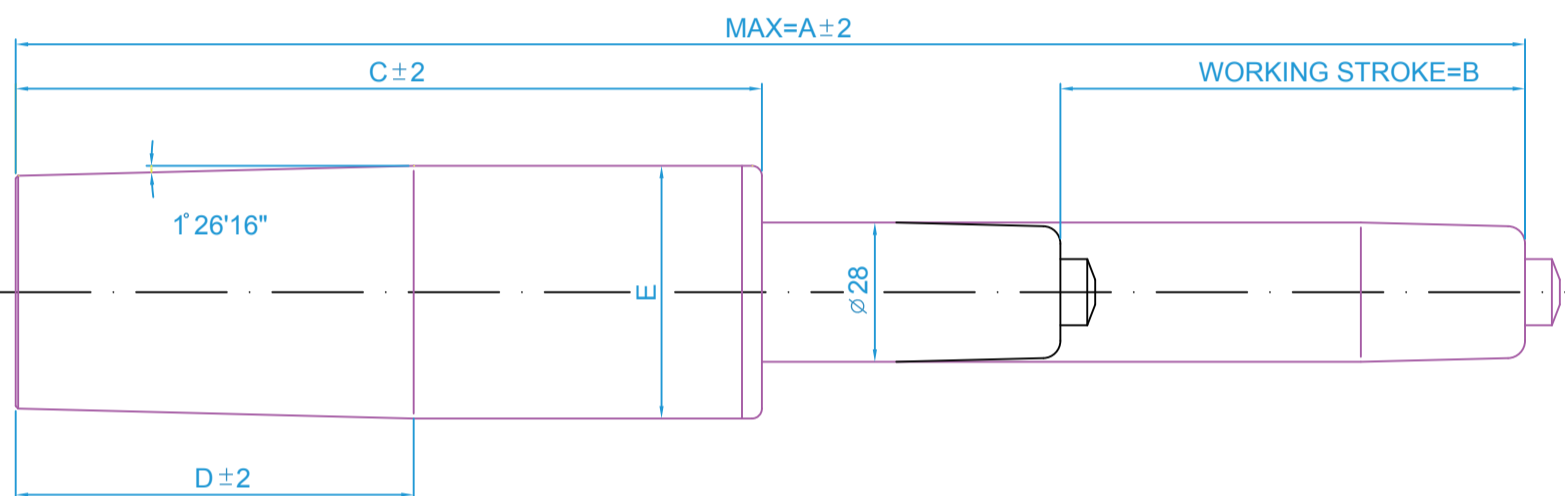

PF REF NO.	A/mm	B/mm	Column Code	φ	C/mm	D/mm
A07AZDW	305	73	SC185	50	185	70
			DC185	50		70 ~ 140
			SC185	50.8		80
			DC185	50.8		80 ~ 140
A07CZDW	347	93	SC205	50	205	70
			DC205	50		70 ~ 160
			SC205	50.8		80
			DC205	50.8		80 ~ 160
A07FZDW	394	113	SC215	50	215	70
			DC215	50		70 ~ 170
			SC215	50.8		80
			DC215	50.8		80 ~ 170
A07GZDW	414	133	SC235	50	235	70
			DC235	50		70 ~ 180
			SC235	50.8		80
			DC235	50.8		80 ~ 180
A07KZDW	535	193	SC285	50	285	70
			DC285	50		70 ~ 180
			SC285	50.8		80
			DC285	50.8		80 ~ 180
A07LZDW	705	263	SC385	50	385	70
			DC385	50		70 ~ 180
			SC385	50.8		80
			DC385	50.8		80 ~ 180