



# KEYSWITCH



PAT. M324277

## DESCRIPTION:

- ZINC ALLOY DIE CAST HOUSING AND CYLINDER WITH NICKEL PLATED.
- 4-DISC TUMBLER CYLINDER.
- TERMINALS AND CONTACTS WITH GOLD PLATED.
- TWO BRASS KEYS.
- RUST PROOF ZINC ALLOY NUT.
- UL APPROVED.

## MATERIALS:

LOCK HOUSING	: ZINC ALLOY DIE-CASTED NICKEL PLATED.
CYLINDER	: 4 DISC TUMBLER CONSTRUCTED, ZINC ALLOY DIE-CASTED NICKEL PLATED.
KEYS	: BRASS, ORIGINAL COLOR OR NICKEL PLATED, SINGLE BITTED.
CONTACTS	: SUPPER HARD COPPER ALLOY, GOLD PLATED.
SWITCH HOUSING	: PBT ( 94V-0 ).

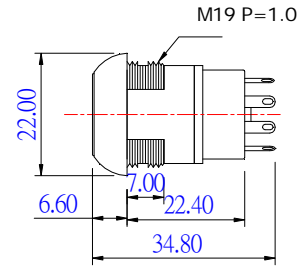
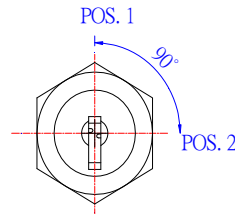

Hold size

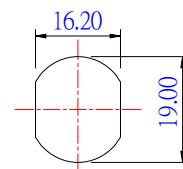
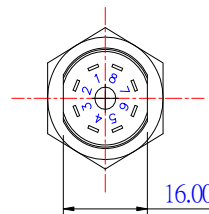

## ELECTRICAL SPECIFICATION:

CONTACT RATING	: 4A 125VAC/28VDC 2A 250VAC
CONTACT RESISTANCE	: BELOW 50 MILLION OHMS.
INSULATION RESISTANCE	: 10 <sup>9</sup> OHMS MIN.
DIELECTRIC STRENGTH	: 6,000 MAKE-AND-BREAK CYCLES AT. FULL LOAD.

ABOVE DATA HAD BEEN PASSED U.L. INSPECTION

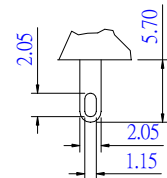
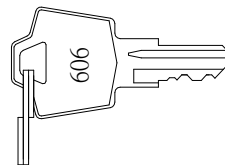

0.50 THK

### LEGEND:

- ▼ =Momenatary position (45°)
- =Delent position (45° or 90°)
- ⊙ =Key pull in these positions
- ▼ or ● or ⊙ = = Stop positions

TERMINAL  
(BOTTOM VIEW)

